



Quarterly Meeting  
July 24, 2025

**Benton Economic Partnership, Inc.**  
**Quarterly Meeting Agenda**  
**July 24, 2025**

7:30 - 7:50	Breakfast & Networking
7:50 - 8:00	Introductions
8:00 - 8:10	BEP Update: Amanda Othoudt, Executive Director
8:10 - 8:25	Breakfast Sponsor Recognition: CentraCare
8:25 - 8:50	Guest Speaker: Darold Berreau from SCORE
8:50 - 9:00	Questions and Adjourn
9:00 - 10:30	Benton Economic Partnership Board Meeting (Private)





## ***GROWTH IN BENTON COUNTY***



- ***Expansions***
- ***New Builds***
- ***Façade Improvements***





# Introductions





BEP Quarterly Meeting  
Breakfast Provided By:  
D&L Catering



# BEP Quarterly Meeting Breakfast Sponsor

Centra Care  
Dr. Jill Amsberry



**MEDICAL SCHOOL**

---

UNIVERSITY OF MINNESOTA

CentraCare Regional Campus  
St. Cloud

A partnership between the University of Minnesota and CentraCare





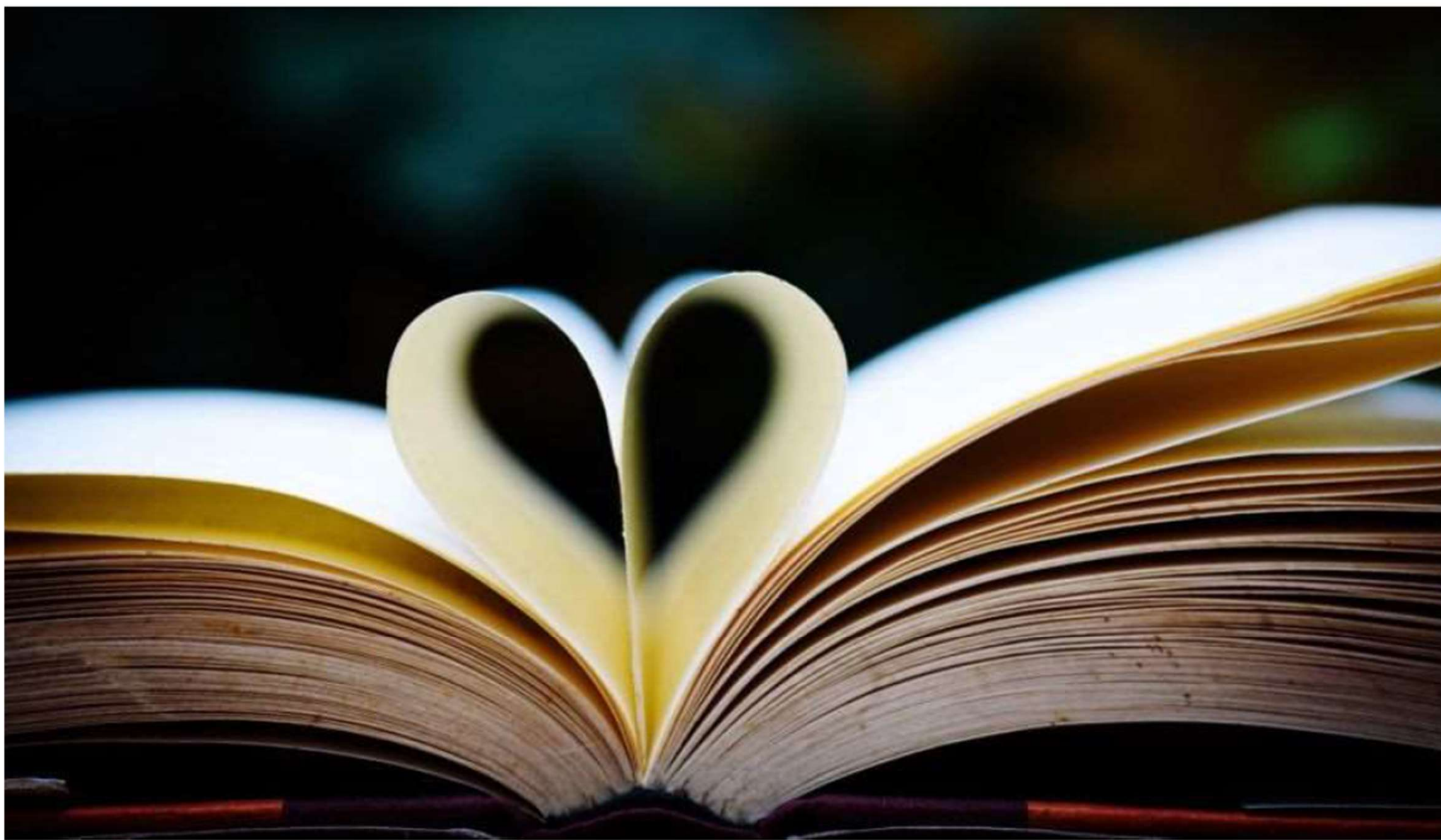



**Where you live, shouldn't determine if you live.**

## If not us, then who? If not now, then when?



While 20% of the U.S. population lives in rural communities, only 11% of physicians practice in such areas.



Only 4% of incoming medical students come from rural communities.



The median age of physicians practicing in rural Minnesota is 59 and one-in-three intend to leave the profession within five years.



The best way to attract new physicians to rural Minnesota is to train them in rural Minnesota.



## Rural areas face severe shortages of primary care physicians

Physicians are in short supply in rural parts of the state.

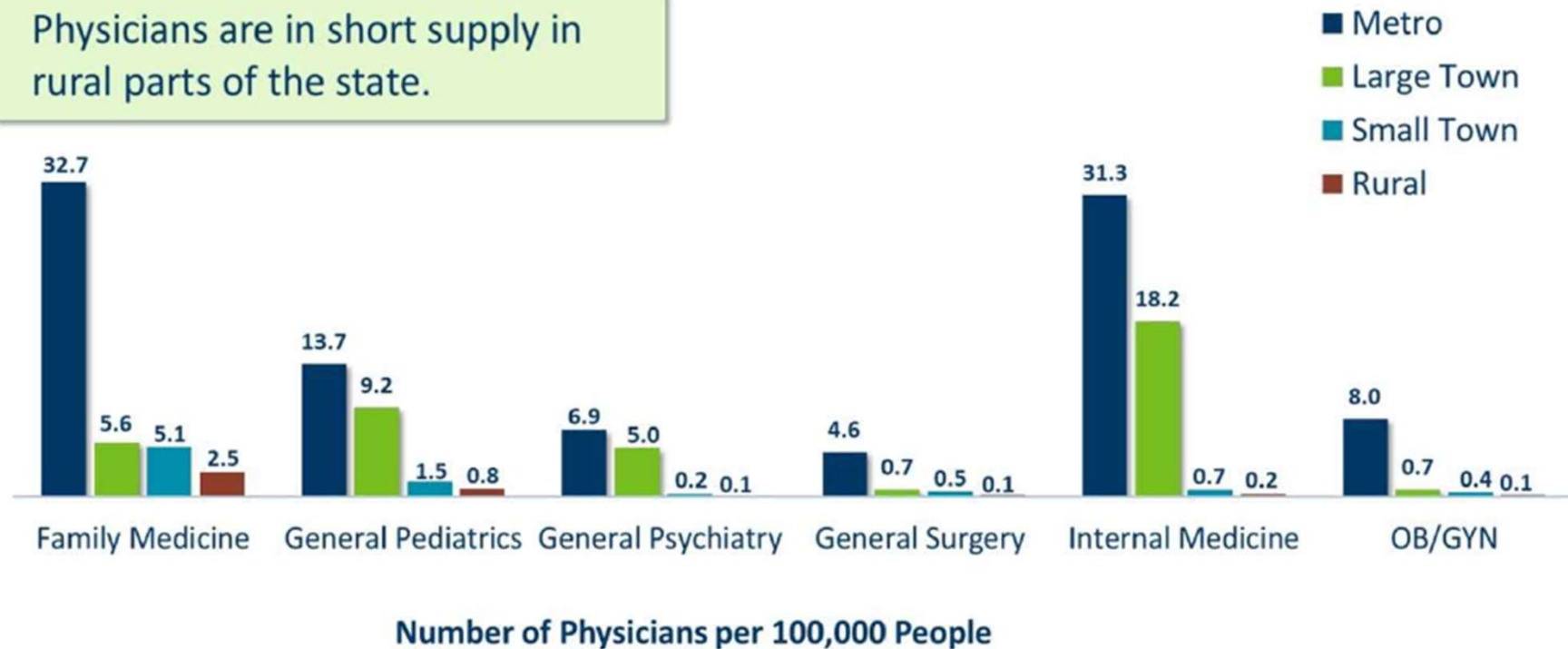

The **median** age of urban providers compare to rural providers

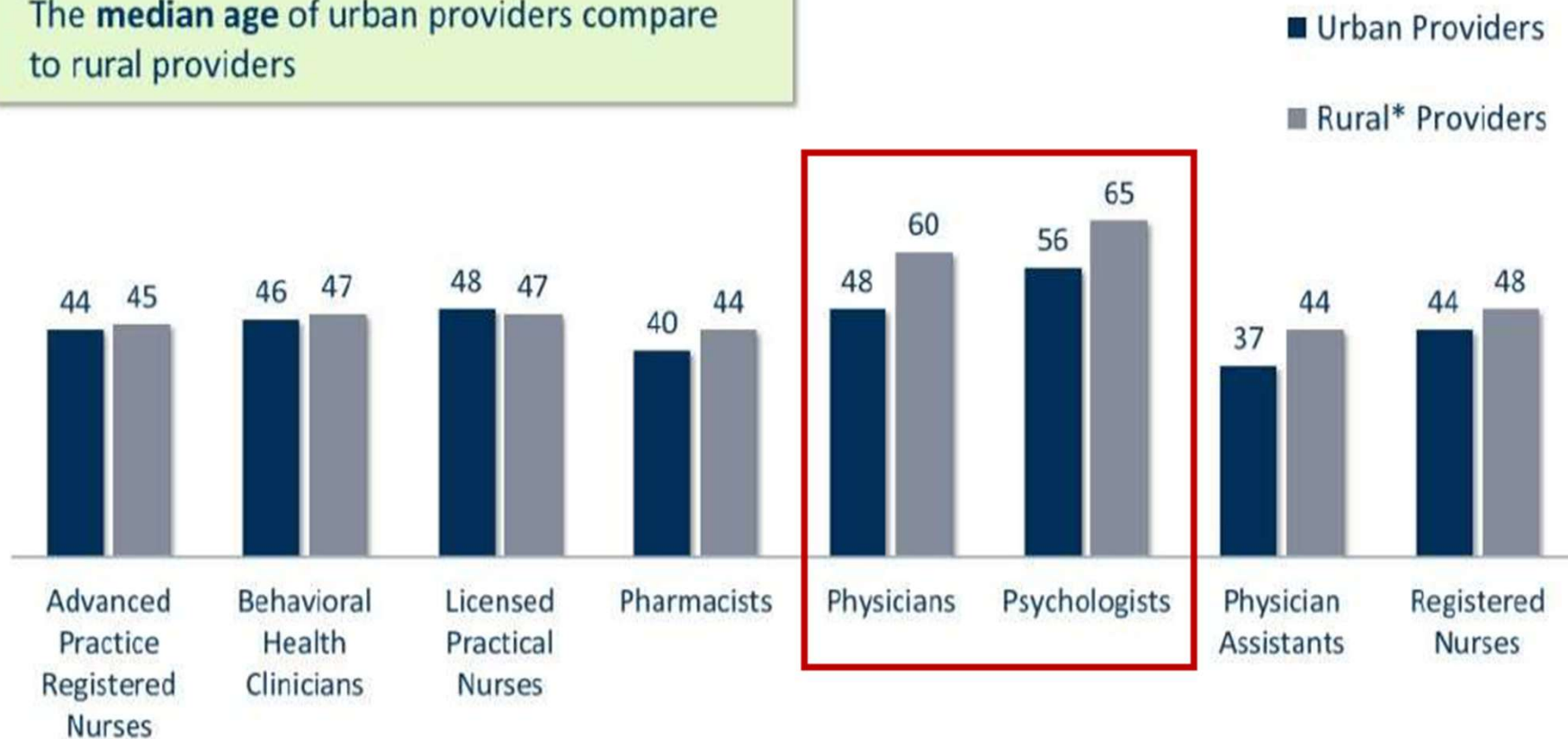

Source: MDH Office of Rural Health and Primary Care analysis. Data provided by Health Licensing Boards, 2024.

\*Rural = isolated rural from Rural-Urban Commuting Area codes.

[Summary of Slide](#)

■ Urban Providers

■ Rural Providers

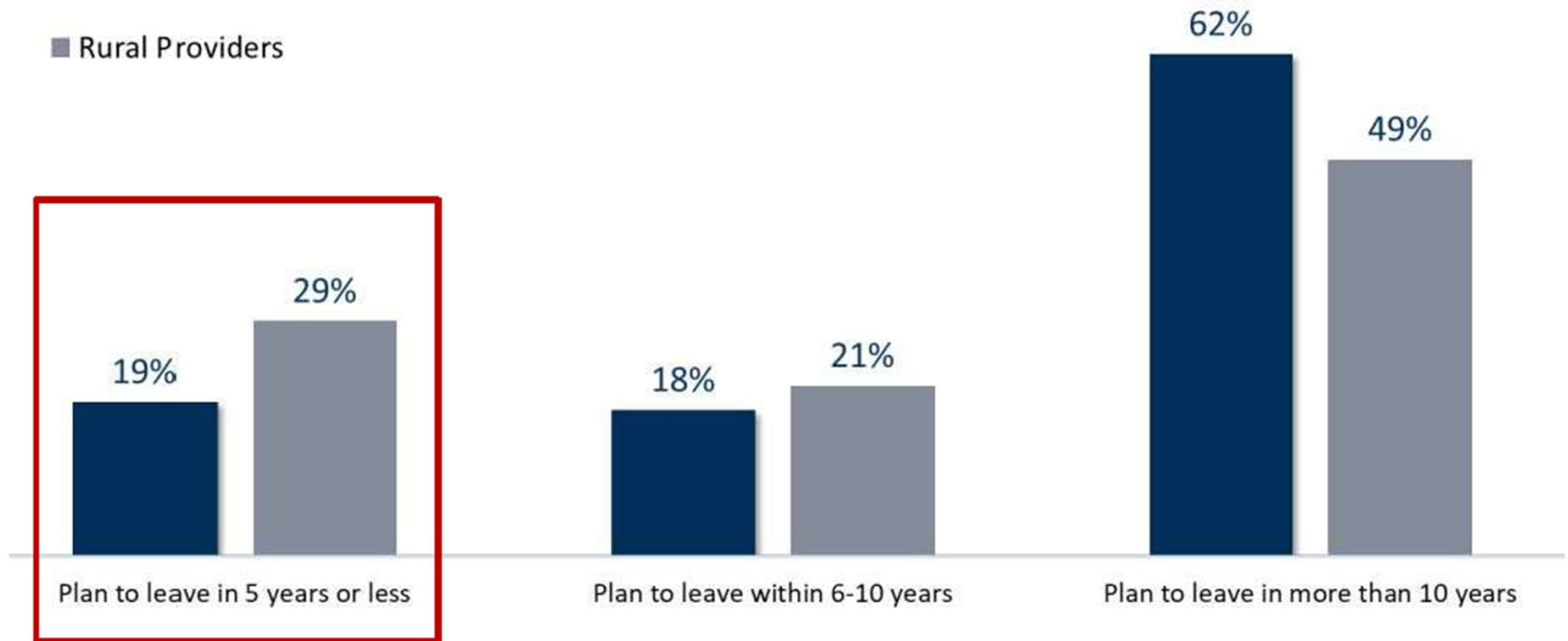

Source: MDH Office of Rural Health and Primary Care, Physician Workforce Survey, 2024.

Rural = isolated rural from Rural-Urban Commuting Area codes.

[Summary of Slide](#)



## Physician Availability in Rural MN

Of the 7,200 federally designated health professional shortage areas:

- 3 of 5 are in rural areas
- 93 are in Minnesota
- 28 are in CentraCare's Service Area

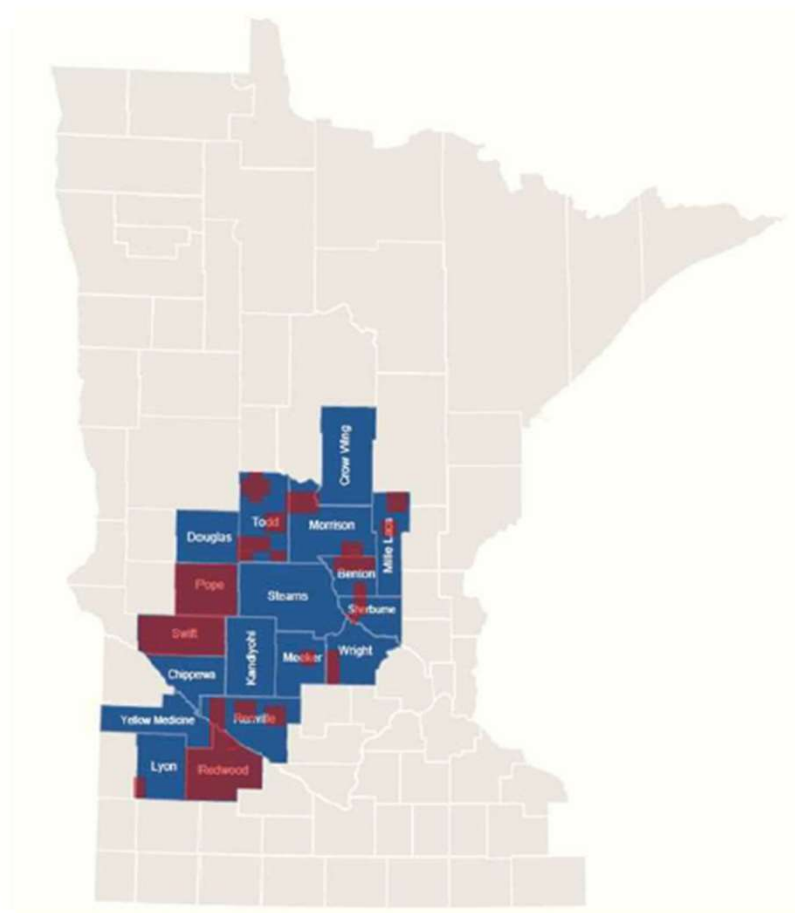

## Factors that Influence Rural Practice Choice

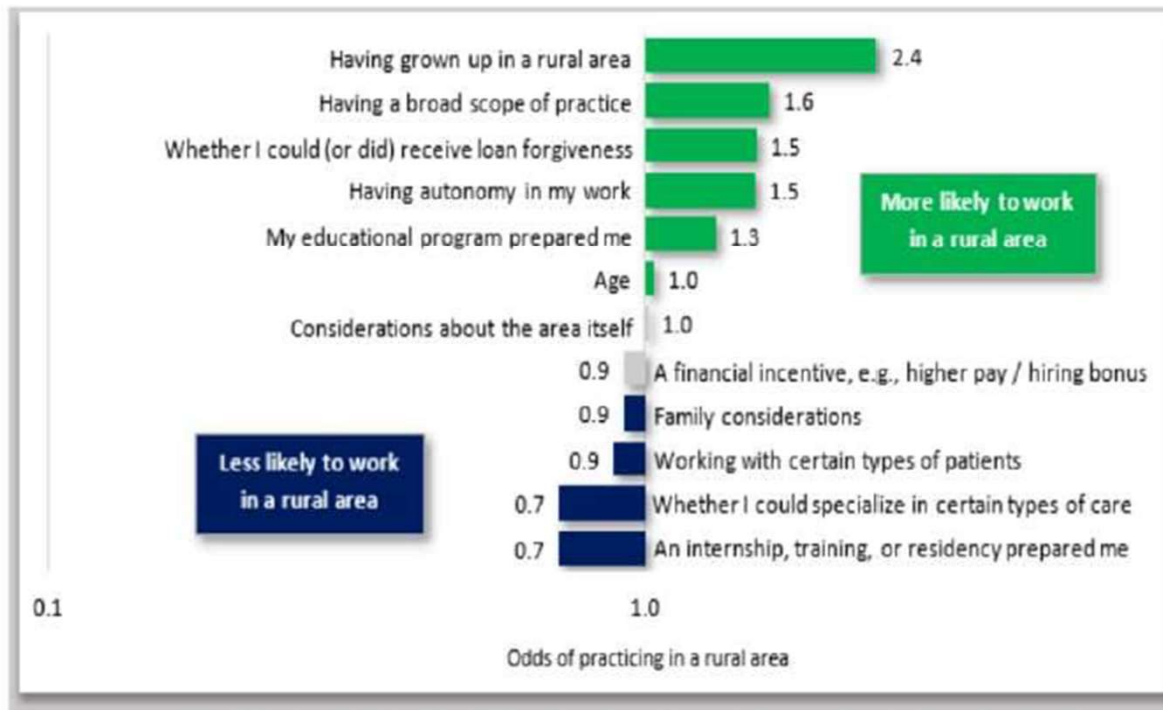

Data source: Analysis of data from the MDH Health Care Workforce Survey, February through December of 2022.

## Validates our approach:

- Recruit students with rural background
- Provide training in a rural environment
- Mitigate educational debt



**MEDICAL SCHOOL**

**Make Rural Life Healthier**

**Will it *actually* help  
our community?**





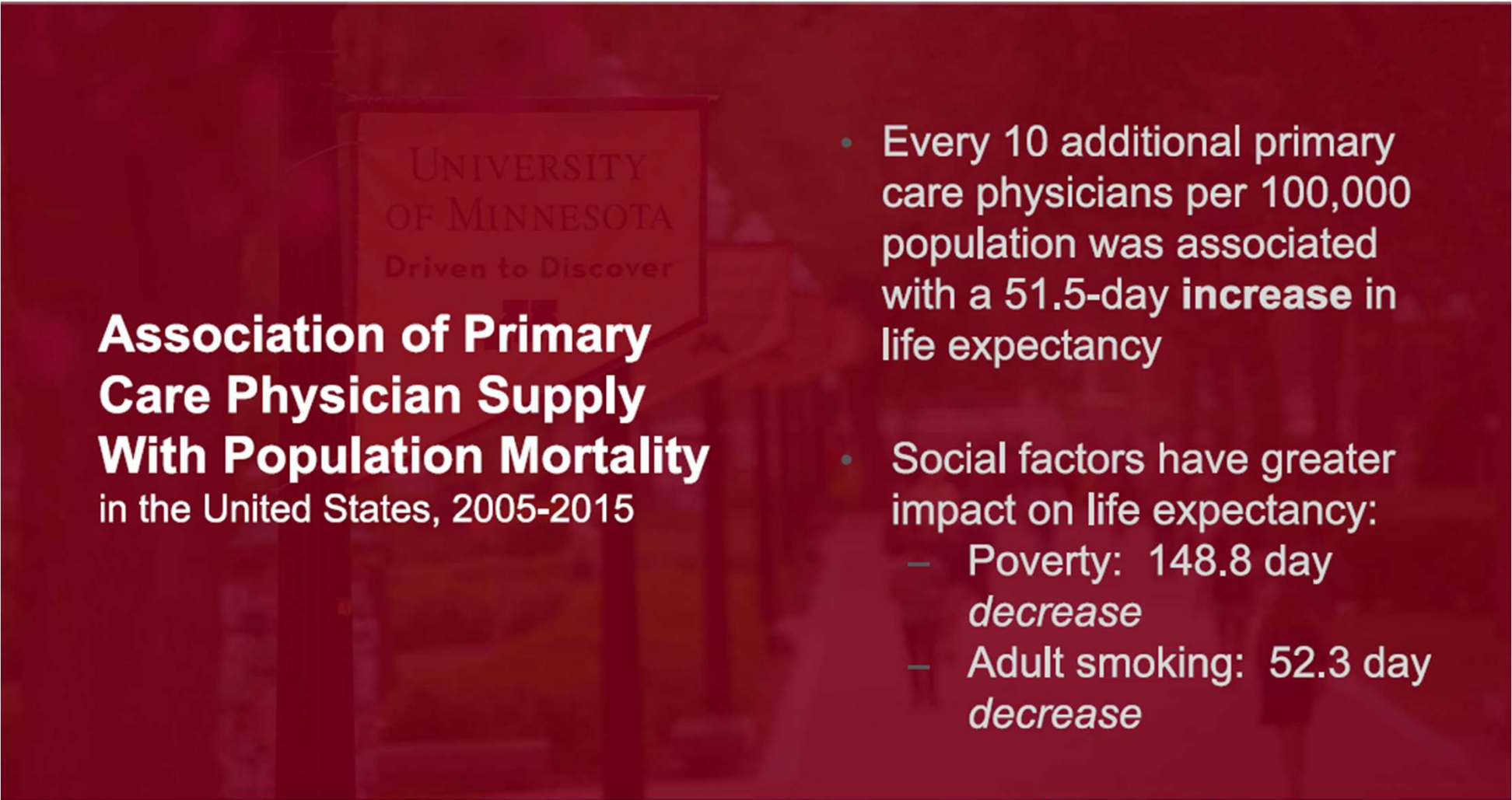

## Association of Primary Care Physician Supply With Population Mortality in the United States, 2005-2015

- Every 10 additional primary care physicians per 100,000 population was associated with a 51.5-day **increase** in life expectancy
- Social factors have greater impact on life expectancy:
  - Poverty: 148.8 day *decrease*
  - Adult smoking: 52.3 day *decrease*



## **Value of Learners to Health Systems**

- Residents play a significant role in quality improvement and patient safety
- Learners contribute to research
- Teaching hospitals are associated with improved clinical outcomes



## **Economic Value of Physicians**

For every 1 practicing physician in a community:

- > 17 jobs added
- > \$1.4 million in wages and benefits
- > \$125K in state taxes

# Timeline

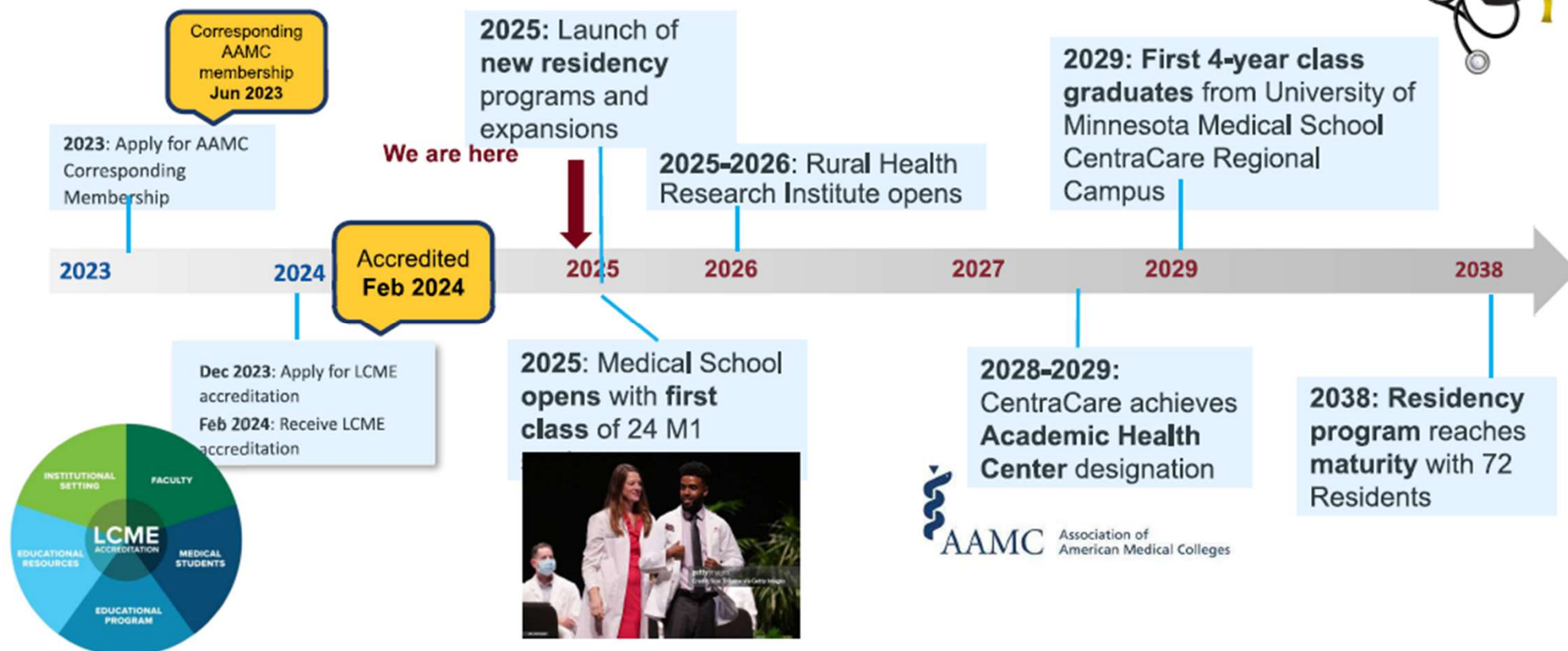

**M MEDICAL SCHOOL**



## Building for the Future

- **What:** A new regional campus of the University of Minnesota Medical School in St. Cloud.
- **Mission:** To train medical students interested in rural healthcare.
- **Why:** To ensure people living in rural communities continue to have access to the care they need.
- **When:** The four-year program will welcome its first class of medical students in the fall of 2025.

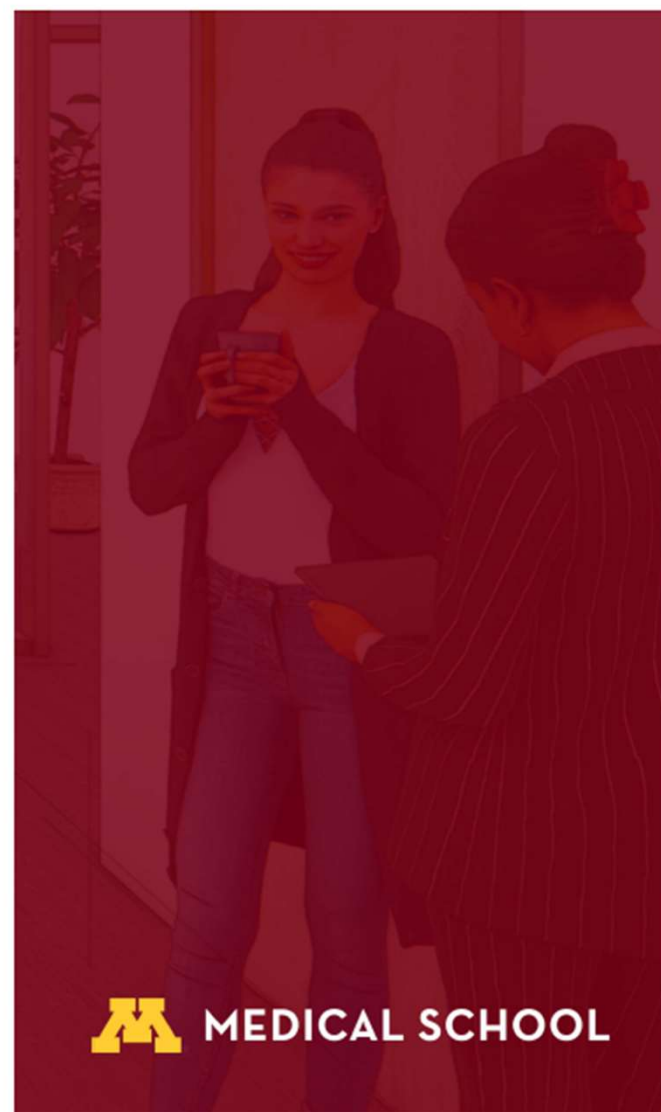





## Campus Snapshot

- **Class size:** 24 students admitted annually (96 students total once the program matures).
- **Location:** 1600 County Road 134, St. Cloud, MN 56303 (formerly CentraCare's Administrative Services Building).
- **Faculty:** Classes led by exemplary faculty from the University of Minnesota and CentraCare.
- **Housing:** A 96-unit housing development next to the campus will be available in the fall of 2025.



## Campus Features

- **Classrooms:** Expansive classroom spaces in the newly renovated facility.
- **Simulation suite:** Includes four simulated clinical exam rooms.
- **Medical simulation flex room:** Used for inpatient hospital, procedure, or operating room scenarios.
- **Full anatomy lab:** A newly designed space with natural light for optimal learning.
- **Wellness spaces:** Exercise areas and outdoor spaces for students.



**MEDICAL SCHOOL**

---

UNIVERSITY OF MINNESOTA

CentraCare Regional Campus  
St. Cloud



## Foundations Phase Sequence

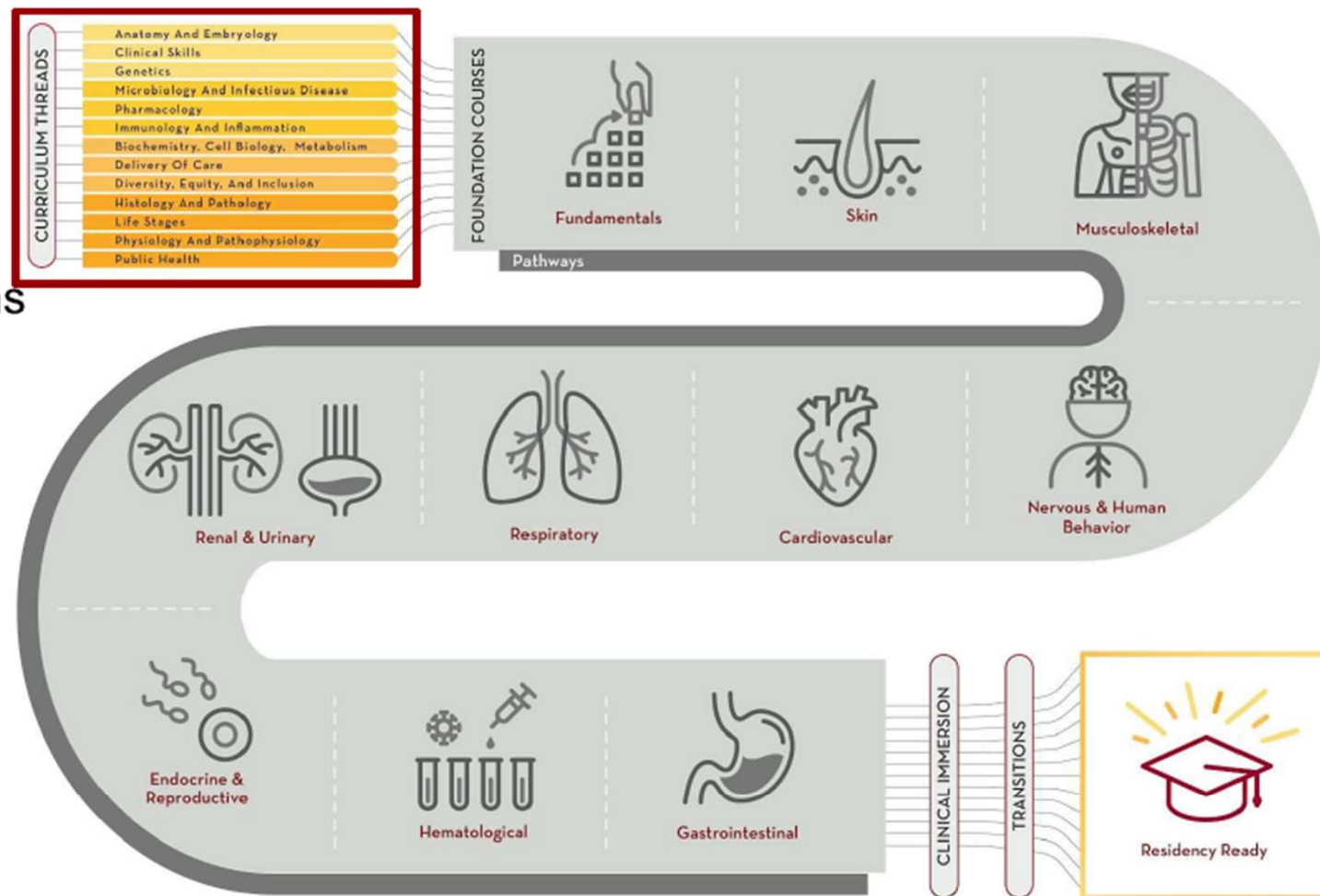



# CURRICULUM THREADS

Anatomy And Embryology

Clinical Skills

Genetics

Microbiology And Infectious Disease

Pharmacology

Immunology And Inflammation

Biochemistry, Cell Biology, Metabolism

Delivery Of Care

Diversity, Equity, And Inclusion

Histology And Pathology

Life Stages

Physiology And Pathophysiology

Public Health

## Students

- **Applications:** More than 200 students named the CentraCare Regional Campus as their #1 choice.
- **Selection process:** All 24 students have been selected for the inaugural class.
- **Orientation week: August 18-21, 2025**
- **White coat ceremony: August 21, 2025**



MEDICAL SCHOOL

## Health Care Professional Shortage Areas Primary Care

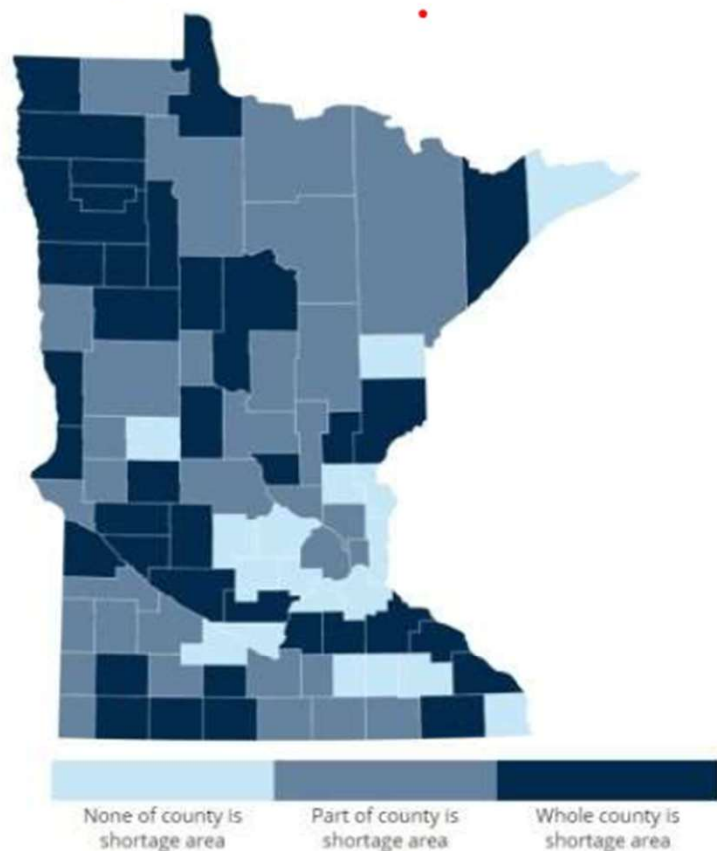

## Inaugural Class

- Retained all 24 students offered admission
- Every student is a Minnesota resident with demonstrated commitment to rural health
- Some recent graduates of local institutions
- Several non-traditional students with exciting background experiences



**MEDICAL SCHOOL**

UNIVERSITY OF MINNESOTA

CentraCare Regional Campus  
St. Cloud





SIMULATION CENTER

**Medical School Campus**





SIM SEMINAR

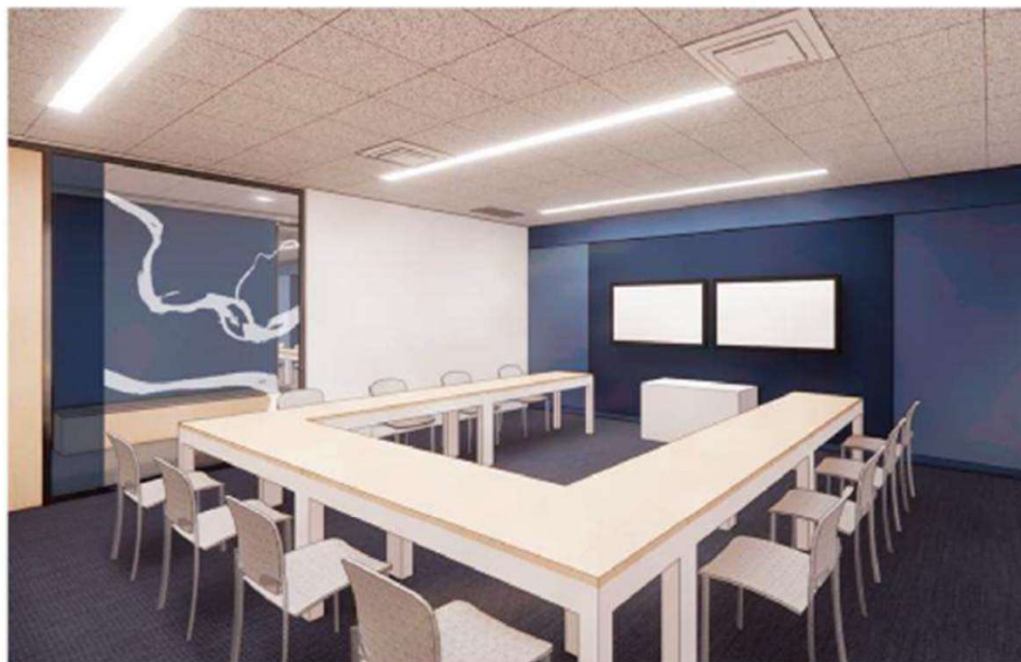

TYPICAL EXAM ROOM











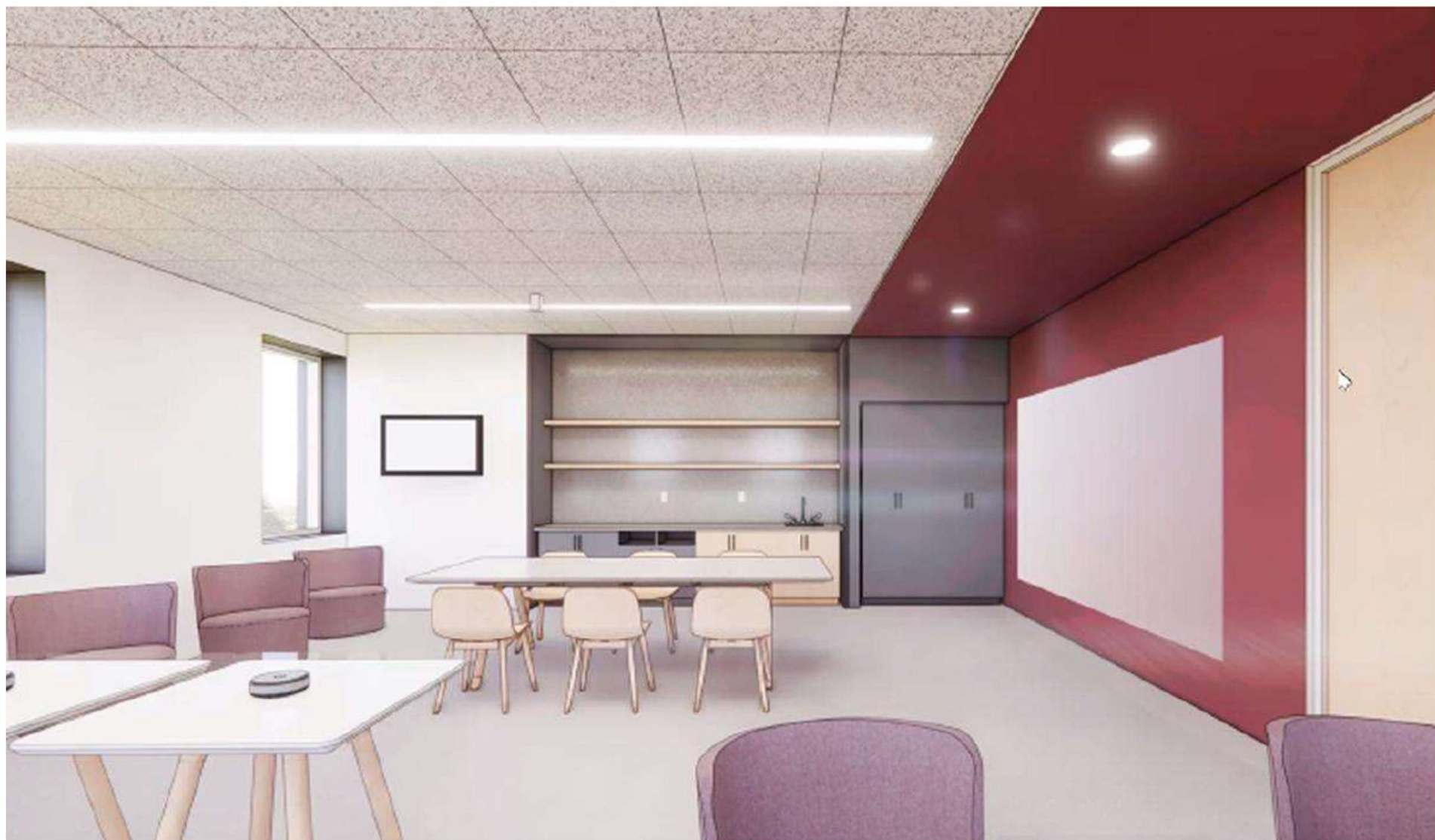





# The Residence at the Plaza















# Graduate Medical Education

Becoming a physician takes multiple steps:

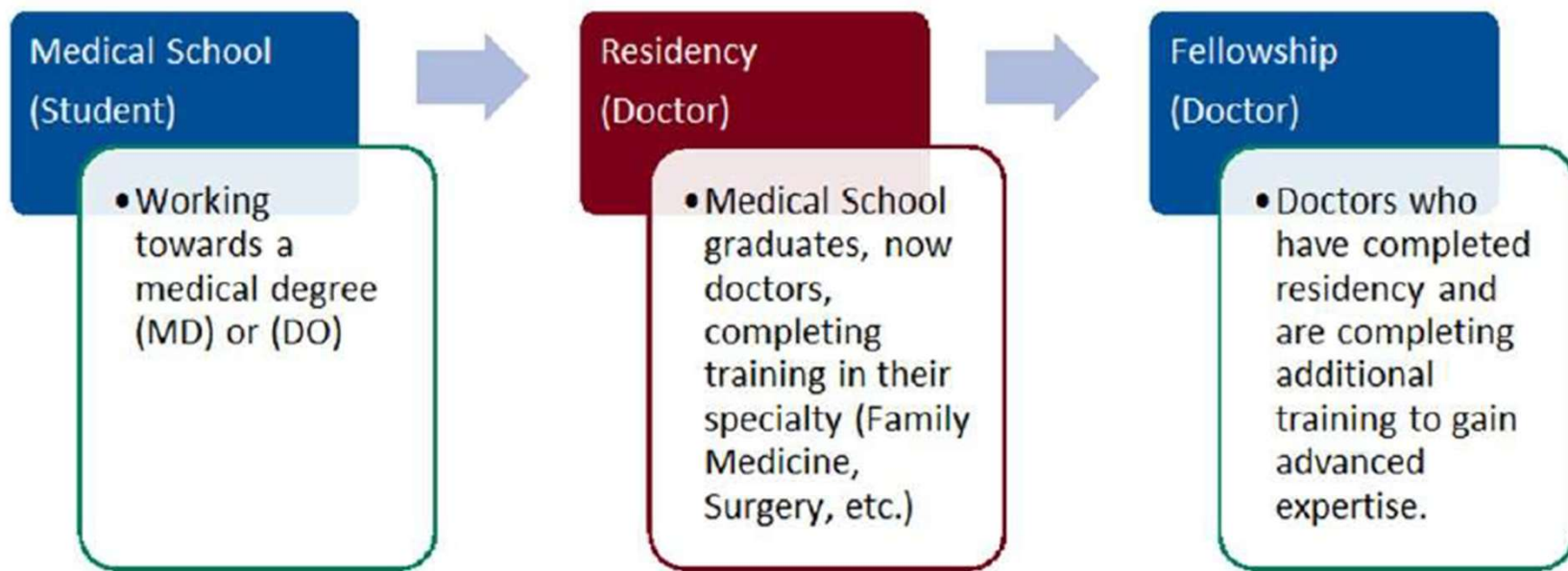



## Track Record of Success

- CentraCare and the University of Minnesota Medical School have partnered on the St. Cloud Family Medicine Residency for nearly 30 years.
- 118 family medicine physicians graduated
- 82% practicing in Minnesota
- 77% practicing outside the 7-county metro
- 51% practicing in communities <25,000 people



# Residency Training Expansion

Physicians often stay where they train so rural training means rural doctors.

					
<u>Family Medicine</u> New Willmar program 2 residents annually First class starting 7/2025!	<u>Pediatrics</u> Primary care/rural track 2 residents annually Starting 7/2027	<u>Psychiatry</u> Rural track 2 residents annually Starting 7/2027	<u>Internal Medicine</u> Rural primary care track 3 residents annually Start TBD	<u>General Surgery</u> Rural track 1 resident annually Starting 7/2027	<u>Obstetrics and Gynecology</u> Rural rotations & advanced family medicine training Start TBD

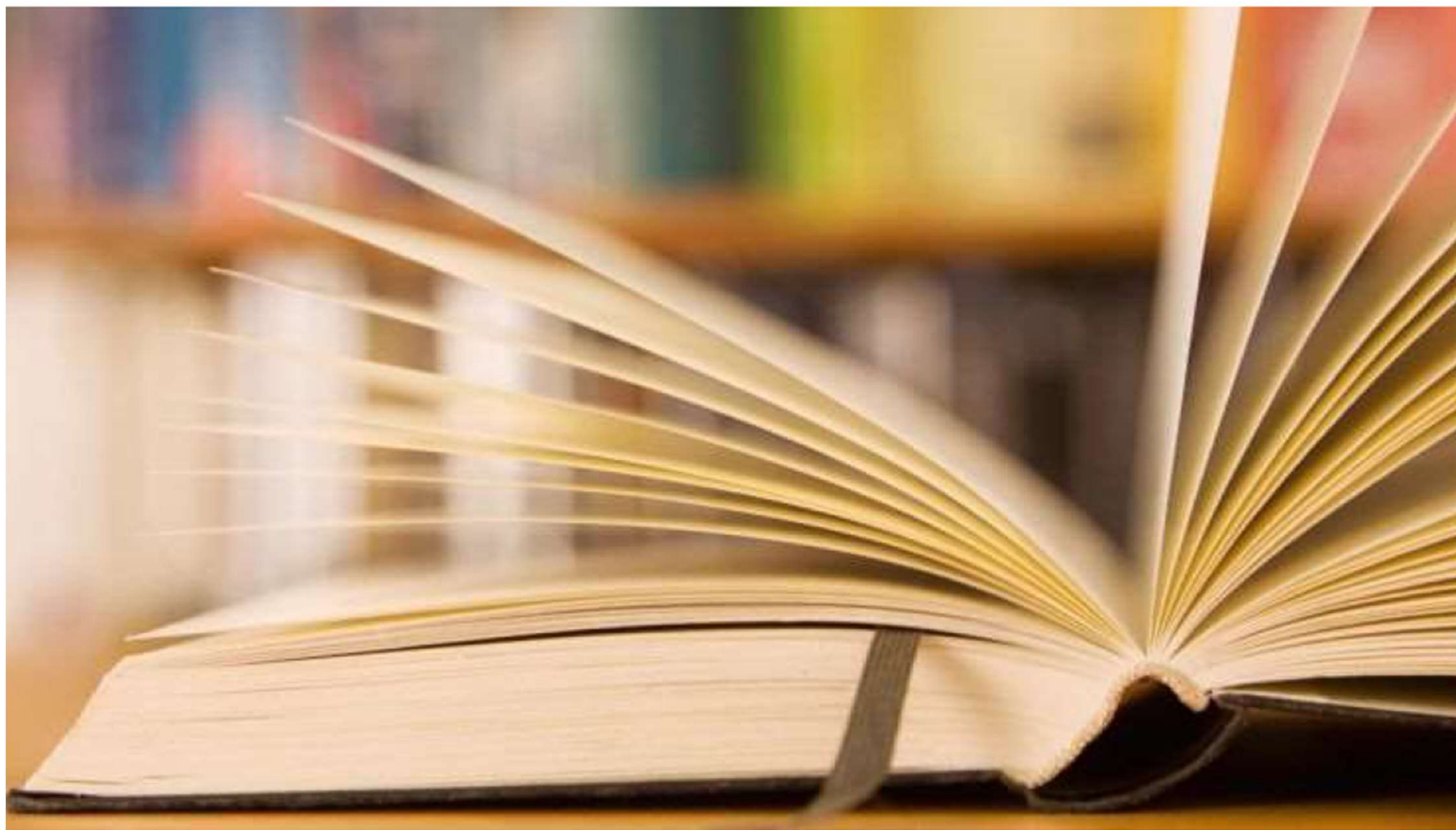







BEP Quarterly  
Meeting  
Keynote Speaker

Darold Berreau





| Twin Cities

# Empowering Entrepreneurs with SCORE

*Presented by: Darold Berreau  
Certified SCORE Mentor  
Twin Cities Chapter*

Go to [twincities.score.org](https://twincities.score.org)



U.S. Small Business  
Administration

# About **SCORE**

- 60 years of volunteer service
- Over **17 million** entrepreneurs supported
- National Non-Profit backed by the U.S. Small Business Administration (SBA)
- **Nationwide network** – 10,000 + expert volunteers across all 50 U.S. states

# Why Entrepreneurship Matters

- In 2024: **5.2. Million** new business applications were filed (U.S. Census Bureau)
- However –
  - **20% fail in year one**
  - **50% fail within five years**



# SCORE's Mission

- Help small businesses **launch, grow, and thrive**
- Provide **FREE** mentoring and training
- Note: starting the end of June (2025), **SCORE** will be charging \$ 25 for National webinars, with the exception of SCORE's sponsored webinars

# Mentorship Makes a Difference

- Entrepreneurs provided **3 +** hours of mentoring see:
  - Higher revenues
  - Increased growth
  - 3x more likely to stay in business
- Mentors offer **advice, best practices** and **expert feedback**

# The Power of SCORE Mentors

- Experienced business professionals
- One-on-One partnerships
- Support through every stage

# Flexible, Professional Mentoring

- In-person, virtual or email
- Local or national experts
- Co-Mentoring teams available



# Business Education Resources

- Webinars (live and recorded) workshops
- Interactive online courses
- Business planning templates, with Mentor review and feedback
- Content tailored to the business **stage, industry, and needs**

# The SCORE Startup Roadmap

- Step-by-Step guidance for new businesses
- Stage-based content: Start – Grow – Transition
- Mentoring tips included throughout

# Take the first step

- **SCORE** is for every entrepreneur and small business owner
- Request your mentor today at: [www.score.org](http://www.score.org)
- It's **FREE**, confidential and effective

# QUESTIONS





# Partnerships



The background of the slide is a dense, out-of-focus field of light blue wooden question marks. The lighting creates soft shadows and highlights on the wood grain, giving it a three-dimensional appearance.

# Questions

Thank you for attending

Private BEP Board Meeting to Follow



Amanda Othoudt, EDFP  
Executive Director  
Phone: 320-968-6197

Pamela Vizenor  
Executive Assistant  
Phone: 320-818-1111



Save the Date: Quarterly Meeting  
October 24, 2025